

Monique Simple Linen Tee Tutorial

Description







One of the most basic and must have pieces in your wardrobe has to be the white tee. A comfortable white t-shirt that you can throw on without much thought for all occasions; wear it with the boyfriend jeans for a casual chic look, or with a blazer and a skirt for a smart work do. Since the classic t-shirt is made out of white cotton, we have matched it with our own Optic White linen. For Monique, we have added small personal touches like the side slits and alternating lengths for the front and back panels makes a bit more interesting and fun. Let us know how you get along.

Materials

1 yard of [IL019 Optic White Softened](#)
Matching sewing thread
1 button



Tools

Pattern master, pattern paper
Paper scissors, fabric scissors
Fabric marker, pins, tape measure
Bias tape maker, hand sewing needles



Time

2-3 hours

Difficulty

Beginner

Step

Note: Prewash your fabric and tumble dry it until it is still slightly moist, let this dry in room temperature.

1. Iron the fabric so it is easier to work with.
2. [DOWNLOAD MULTI-SIZED PATTERN HERE](#)
3. Use a serger, or choose your own method to protect the seams from fraying. Make sure the method you choose does not add weight to the fabric.
4. First, we will make the slit for the back, since linen doesn't stretch it's necessary' to allow more space for your head to fit through. Take your back panel. Make a slit mark measuring 3 inch in length right in the centre of the neckline.



5. Place both panels one on top of each other, with the wrong side facing out. Pin together the shoulder seams, stitch along and press open.



6.' Match the notched centre point of the sleeve to the sewn shoulder seam, pin along the whole width of the sleeve panel. Stitch along, but leave $\frac{3}{8}$ in (1cm) of the material unsewn at both ends of the sleeve panel.

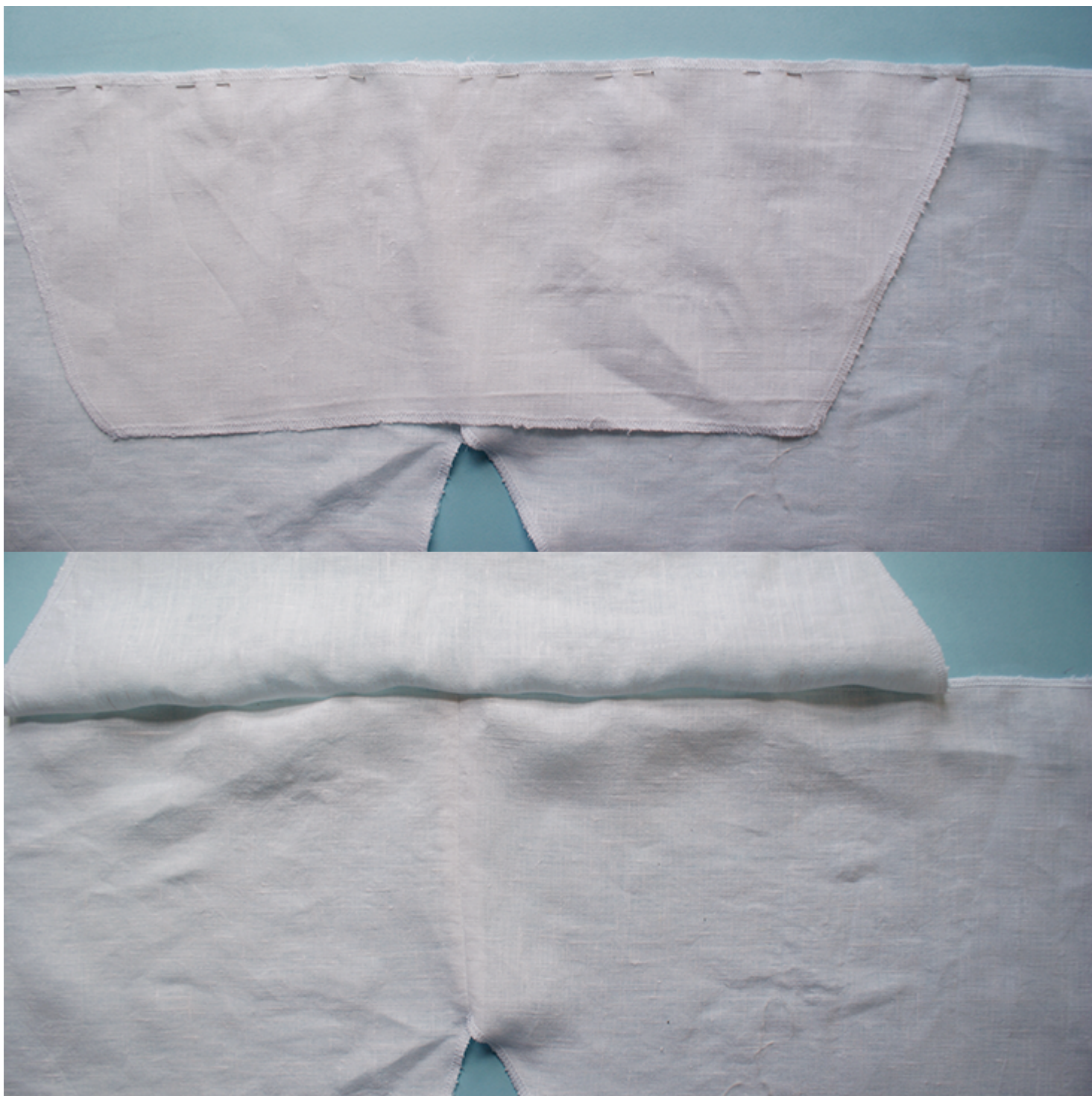

7. To make the side slit opening, measure and mark 1.5 in from the bottom hem of' your front panel.



8.' Pin together the sleeve seam as well as the bodice side seam. Stitch along the pinned edge and press open.

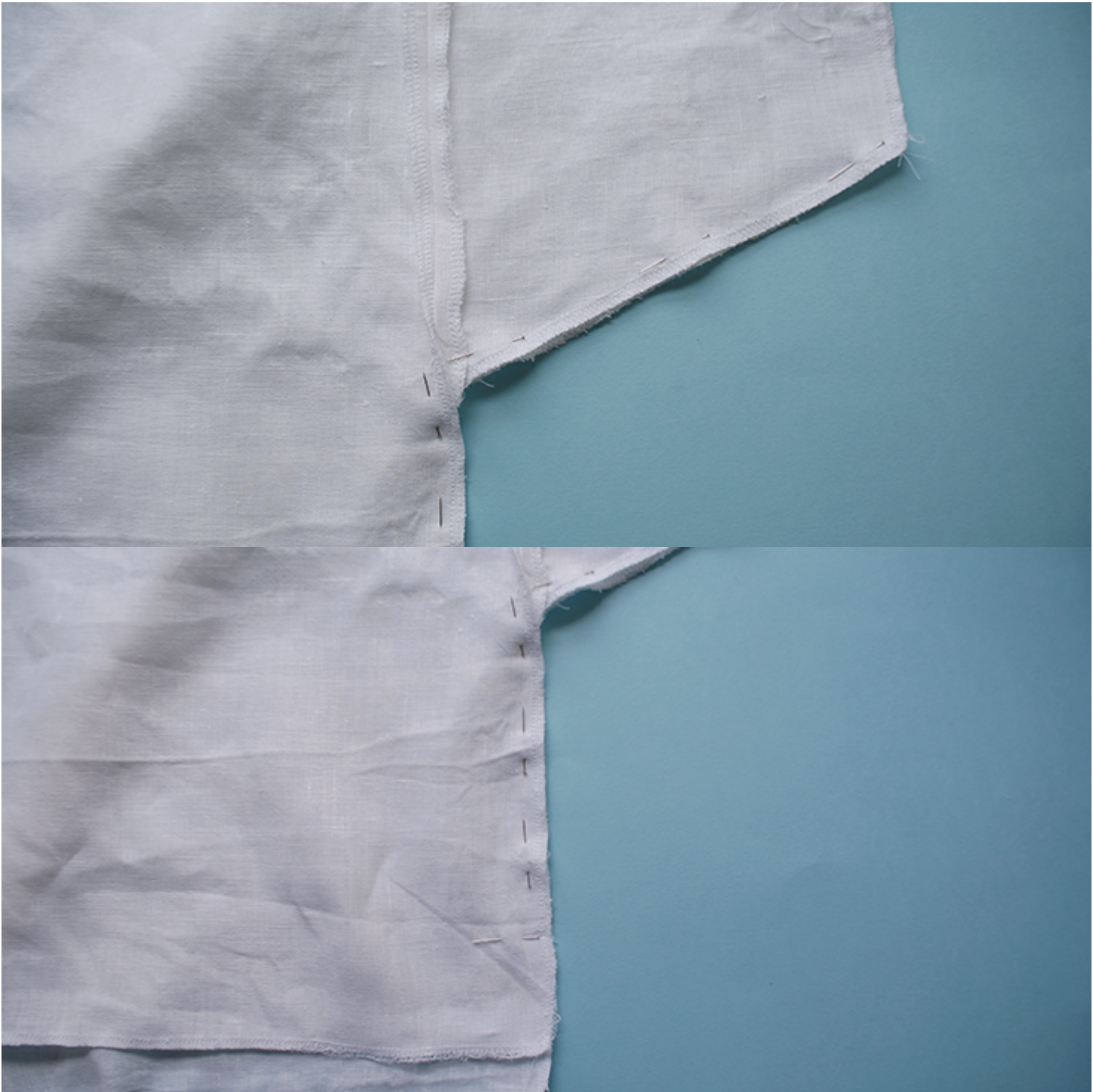

9.' Next, we will finish all hems except for the neckline. In all cases, the seam allowance should be folded inwards onto its wrong side, so essentially onto the inside of your tshirt. Start with the sleeve hems. Press the sleeve hems on both arms.' Top stitch over this.

10. Continue pressing the bottom hems, including both slits. Top stitch over this pressed edge.



11. Cut more' material from the back slit opening, to make a wider curve.



12. Following [this tutorial](#), make' around 1.5 yards (1m) of bias binding tape.

13. Pin the tape along the back slit opening. Top stitch over the pinned edge.



14. Next, take some tape you have already made, half the width and make' 3 in (7cm) of thinner tape. This will be used as your button loop.

15. Pin this on the left of the back neck opening, as shown in the photo below. Sew along this and trim away excess loop after sewing.

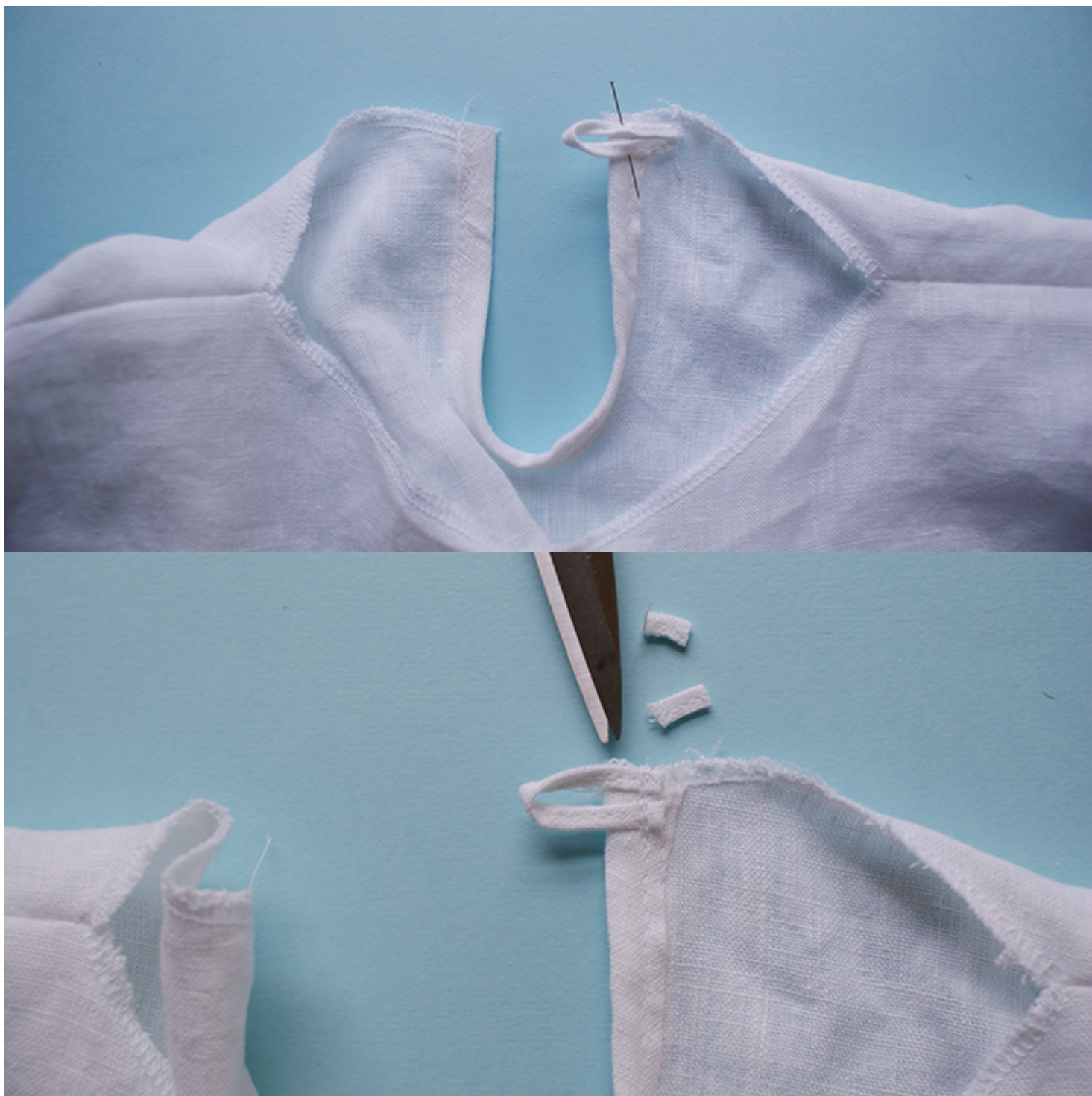

16. Pin your initial tape along the whole collar and top stitch along this.



17. Finally, on the right side where the button loop overlaps, sew on the button by hand.



If you think you don't need another white t-shirt, why not check out all the other colors we have and play around with all the

possibilities you can find?

CATEGORY

1. TUTORIALS

POST TAG

1. fabrics-store
2. fabrics-store.com
3. free
4. free tutorial
5. linen
6. linen fabric
7. linen ideas
8. linen tshirt
9. sewing
10. sewing tips
11. sewing tutorial
12. tee
13. textiles
14. tutorial
15. women

Category

1. TUTORIALS

Tags

1. fabrics-store
2. fabrics-store.com
3. free
4. free tutorial
5. linen
6. linen fabric

- 7. linen ideas
- 8. linen tshirt
- 9. sewing
- 10. sewing tips
- 11. sewing tutorial
- 12. tee
- 13. textiles
- 14. tutorial
- 15. women

Date Created

November 23, 2015

Author

cynthia-fong